



4, 1 Woodbine Place, Oxford, OX1 1JS

Welcome to this charming studio apartment located at Woodbine Place, available for the 2026/-27 academic year. This delightful one-bedroom property is perfect for students seeking a comfortable and convenient living space. The studio features a well-designed built-in kitchenette, allowing for easy meal preparation, and an en suite bathroom that offers both privacy and convenience.

One of the standout features of this apartment is its proximity to the train station, just two minutes away. This makes commuting a breeze, whether you are heading to lectures or exploring the beautiful city of Oxford.

Additionally, residents will appreciate the bike storage available and the courtyard garden provides a lovely outdoor space to relax and unwind, making it an ideal spot.

- Oxford City Centre
- 1 Bedroom
- 1 Bathroom
- Furnished Property
- Studio

****This property is only available to students & single occupancy only****

£1,175

GROUND FLOOR

APPROX. 14.6 SQ. METRES (157.3 SQ. FEET)

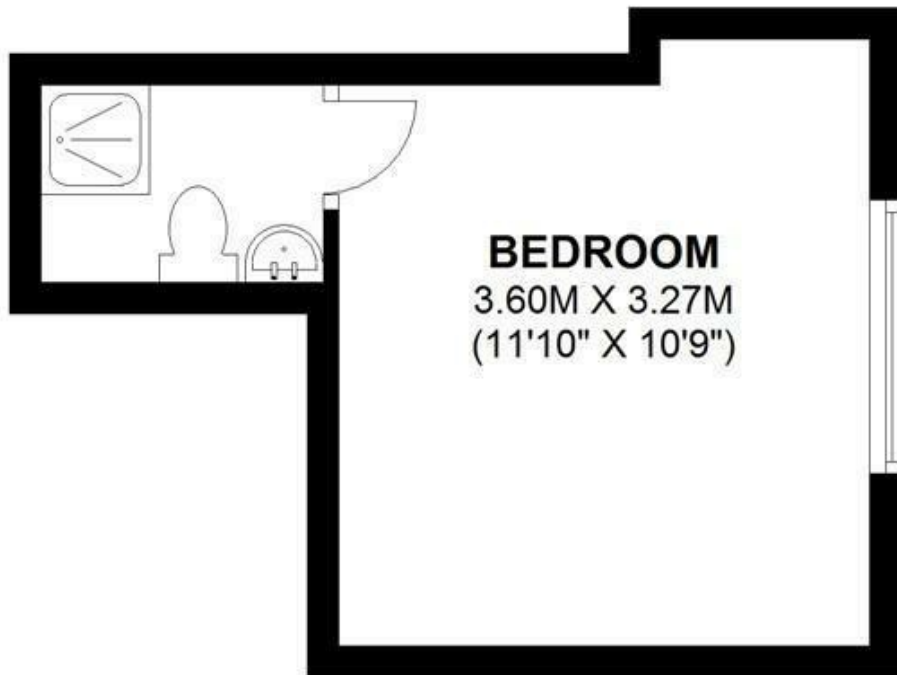

TOTAL AREA: APPROX. 14.6 SQ. METRES (157.3 SQ. FEET)

Energy Efficiency Rating		
	Current	Potential
Very energy efficient - lower running costs		
(92 plus) A		
(81-91) B		
(69-80) C		
(55-68) D		
(39-54) E	57	59
(21-38) F		
(1-20) G		
Not energy efficient - higher running costs		
England & Wales EU Directive 2002/91/EC		

Environmental Impact (CO ₂) Rating		
	Current	Potential
Very environmentally friendly - lower CO ₂ emissions		
(92 plus) A		
(81-91) B		
(69-80) C		
(55-68) D		
(39-54) E	49	51
(21-38) F		
(1-20) G		
Not environmentally friendly - higher CO ₂ emissions		
England & Wales EU Directive 2002/91/EC		